

Upgraded Ink Fountain

for the Stolle Rutherford Decorator

Stolle Rutherford Decorator

Technical Update 1202-2

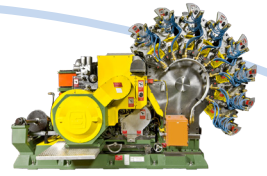

Stolle has developed a new high capacity Ink Fountain and Fountain Roll for the Rutherford ink station. The new design fountain can be retrofitted to any CMP or CD2 style inkers, and will provide several important benefits for operation, print quality and maintenance.

These benefits include:

- 40% increase in ink capacity over the equivalent width current fountain
- Removable ink tray allows cleaning and filling off line for quicker change-overs
- 8 key segmented blade gives precise control of ink flow across the entire label with less heat buildup in the roll and less wear on the blade
- Quick removal of fountain only with no tools and without removal of the fountain roll
- Side plate cheek seals seal tightly to the fountain roll on fixed surfaces. No relative motion between the roll and the side plates eliminates ink leakage, part wear and heat buildup
- Fountain leveling bracket is completely adjustable providing adjustability for ink flow, and allows for inkers to be installed in any station
- No rework is required on CD2 style inkers and minimal rework is required on the CMP style inkers

Upgraded Rutherford Ink Fountains are available to fit different types and sizes of Rutherford inkers.

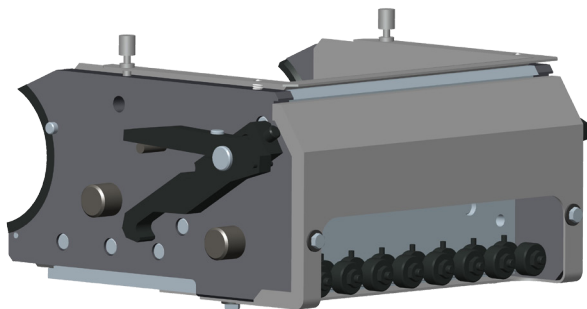

New design fountain has 40% more ink capacity

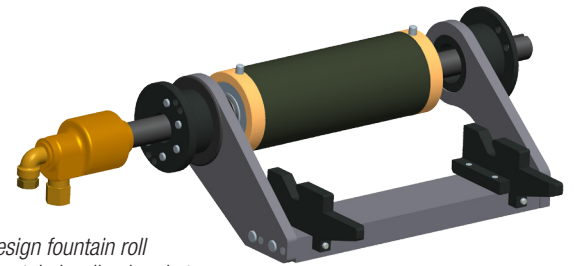
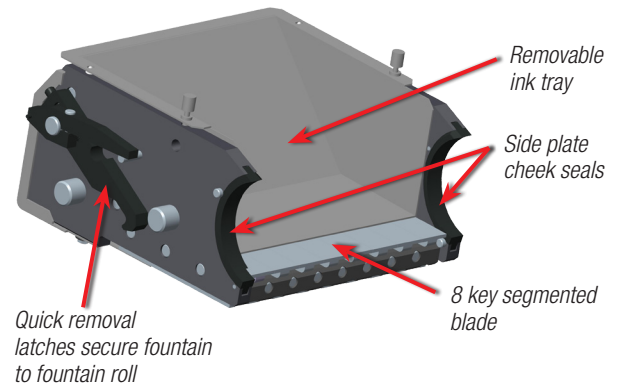

New design fountain roll with fountain leveling brackets

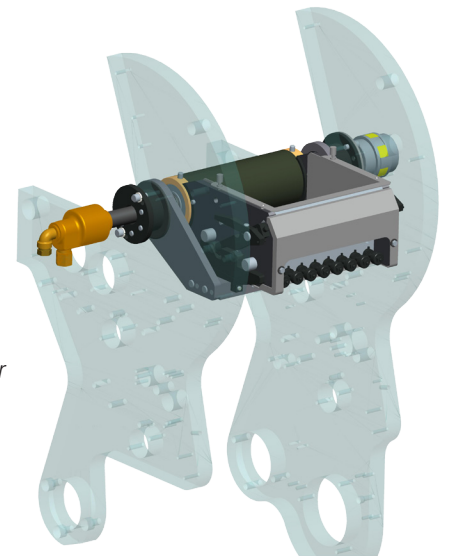

Fountain and fountain roll mounted in inker assembly



Stolle Machinery Company, LLC

6949 South Potomac Street, Centennial, CO 80112
Phone: +1 303-708-9044 Fax: +1 303-708-9045
www.stollemachinery.com

For more information and pricing, please contact Mark Santos at Stolle Centennial at +1 303-708-5173 or mark.santos@stollemachinery.com.

A constant flow of innovations, technology and ideas that benefit customers.